



Ferney Nature Lodge



FACTSHEET

ABOUT

Ferney Nature Lodge

Set in the heart of the valley, Ferney Nature Lodge is where nature, light and luxury exist in perfect osmosis.

The promise of a unique immersive experience, the 4 individual lodges were designed to offer a high level of hospitality and comfort with a private butler to cater to your every whim. Each lodge features an ensuite bathroom with an Italian shower, a selection of complimentary beverages and a private terrace, where one can marvel at the valley skimming with the sky.



15 minutes away from the airport

LODGE HIGHLIGHTS

4 elegant and comfortable double 32 m ² bedrooms
Local and seasonal cuisine
Shared infinity pool
A cosy communal lounge with fireplace and bar
Butler service
Free WiFi access
Free access to La Vallée de Ferney
Access to the Ferney Falaise Rouge restaurant for lunch

PLAN OF INDIVIDUAL LODGE



PLAN OF THE MAIN LODGE

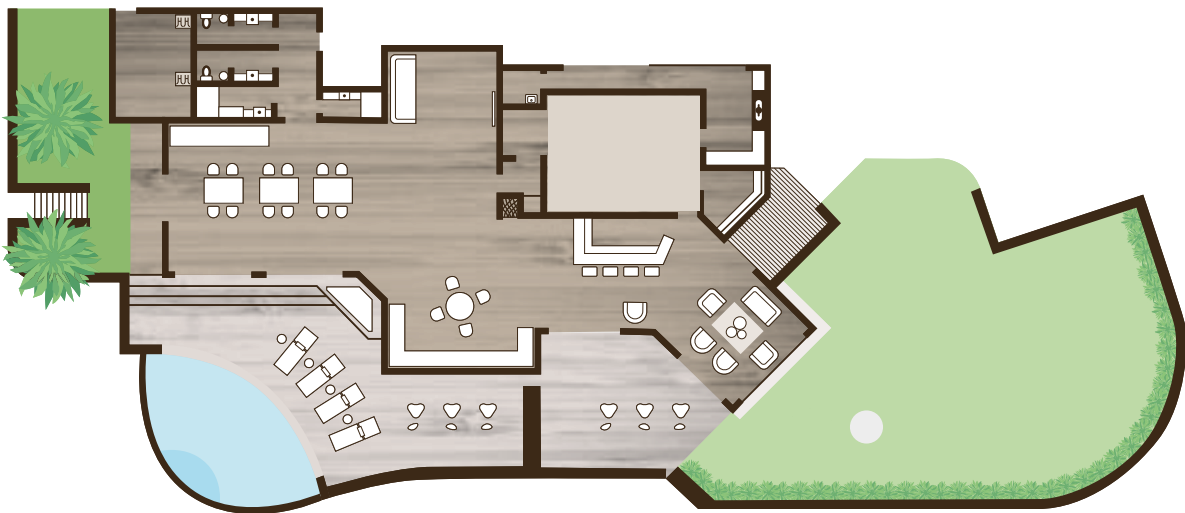

ACCOMMODATION

Name of lodges	Maximum capacity per lodge	Surface area	Accommodation
KESTREL	2 adults and 2 children (0 - 12 years old) Or 2 adults and 1 teenager (13 - 17 years old)	32m ²	<ul style="list-style-type: none"> • 1 double bedroom • King size bed and a sofa bed • One en-suite bathroom • Terrace with panoramic view of the valley • Baby cot bed available on request • Free tea and coffee facilities as well as mineral water are available in each lodge • Free WIFI in the room • Air conditioning • Ceiling fan • Safe deposit box • Telephone • Mini bar • Electric kettle • Hair dryer • Dressing
ECHO-PARAKEET	1 adult and 3 children (0 - 12 years old) Or 1 adult, 1 teenager (13 - 17 years old) and 2 children (0 - 12 years old)		
PINK PIGEON	1 adult and 2 teenagers (13 - 17 years old) Or 3 teenagers (13 - 17 years old)		
PARADISE FLYCATCHER	4 children up to 12 years old		



MEAL PLAN

Service	Opening Hours	Venue	Half-Board	Full-Board
• English breakfast	8.00 am - 10.00 am	Main lodge	✓	✓
• À la carte lunch	12.00 pm - 2.00 pm	Main lodge Or Ferney Falaise Rouge restaurant	Add-on	✓
• Dinner Set menu (starter, a selection of 3 main courses & dessert)	7.00 pm - 9.00 pm	Main lodge	✓	✓

CHECK IN / CHECK OUT POLICY

Check in: 2.00 pm | Check out: 11.00 am

The check in procedure is from 1.30 pm and is done at the reception of La Vallée de Ferney found at the colonial house. Opening hours of La Vallée de Ferney are from 8.30 am to 5.00 pm.

A transfer is provided at the time of check in and check out. Any other transfer request will be provided as per availability.

Early check in as from 11.30 am or late check out until 2.00 pm is included in a full board package. For guests with a half board package, there will be an extra charge of 50 EUR. Both early check in and late check out are at the main lodge and are subject to availability.

ADDITIONAL INFORMATION

- Our personnel is available at the lodge from 8.00 am to 10.00 pm.
- Any dietary restrictions and allergies must be communicated prior to arrival.
- ID cards or passports will be asked upon check in.
- Baby cots must be booked in advance.
- It is recommended to have a 4x4 or SUV to access the Lodge.
- No outside food or drink is permitted.
- Pets are not allowed in the Ferney Nature Lodge.
- Fireworks are not permitted



ACTIVITIES AT FERNEY NATURE LODGE

WELLNESS

- Morning yoga sessions
- Selection of in-room massages

IMMERSIVE EXPERIENCE IN NATURE

- Free access to the open tracks (5km, 13km and 18km)
- Guided tour of Ferney Conservation Park
- Guided 4x4 safari tour of the valley
- Wildlife Dusk Safari in the valley
- Guided tour of the Sensory Garden



FERNEY FALAISE ROUGE - RESTAURANT

- Open from Monday to Sunday from 9.30 am to 5.00 pm
- Kitchen open from 11.30am to 3.00 pm
- 50 guests
- Farm to table concept
- Panoramic seaview of Vieux Grand Port bay
- Authentic Mauritian cuisine

LA VALLÉE DE FERNEY

- Open Monday to Sunday from 8.30 am to 5.00 pm
- 3100 ha estate
- 200 ha conservation area

Contact us for more information

(+230) 5729 1080 | 660 1937

info@ferney.mu

B28 Vieux Grand Port, Mahebourg, Mauritius

FERNEY.MU
